

# BPS AirMini 24V Power Converter

ResMed AirMini CPAP devices operate from 24V direct current and the Freedom™ CPAP Battery operates from 12V direct current; therefore, the use of the BPS AirMini 24V Power Converter is required to convert the Freedom™ battery voltage from 12V to 24V in order to power the AirMini CPAP device.

## SPECIFICATIONS

- Input: 12V DC
- Output: 24V/3.75A (max)
- Length: 68" (end to end)
- Weight: 4 oz.

## SINGLE BATTERY CONNECTION

- Plug the AirMini output cable into the 24V power converter box.
- Plug the 24V power converter with AirMini output cable attached into the DC OUT jack of the Freedom™ battery and then into the DC input port of the AirMini CPAP device.
- Turn on the AirMini CPAP device and it should begin functioning.

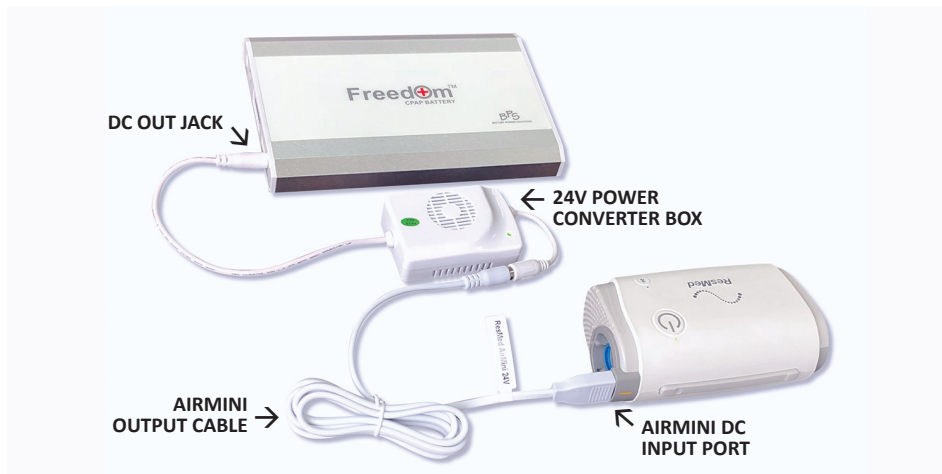

## DUAL BATTERY CONNECTION

- Plug the DC power pigtail cord that was included with the Freedom™ CPAP Battery Kit into the DC OUT jacks of both Freedom™ batteries.
- Plug the 24V power converter box into the DC power pigtail cord.
- Plug the AirMini output cable into the 24V power converter box.
- Plug the 24V power converter box with AirMini output cable attached into the DC input port of the AirMini CPAP device.
- Turn on the AirMini CPAP device and it should begin functioning.



**NOTES:** To avoid using battery power to maintain the AirMini Bluetooth connection, it is recommended that you turn off your Bluetooth connection when using the Freedom™ battery to power the AirMini CPAP device. When not in use disconnect devices from the Freedom™ battery to allow the battery to completely shut down.